

Air Handler Specifications

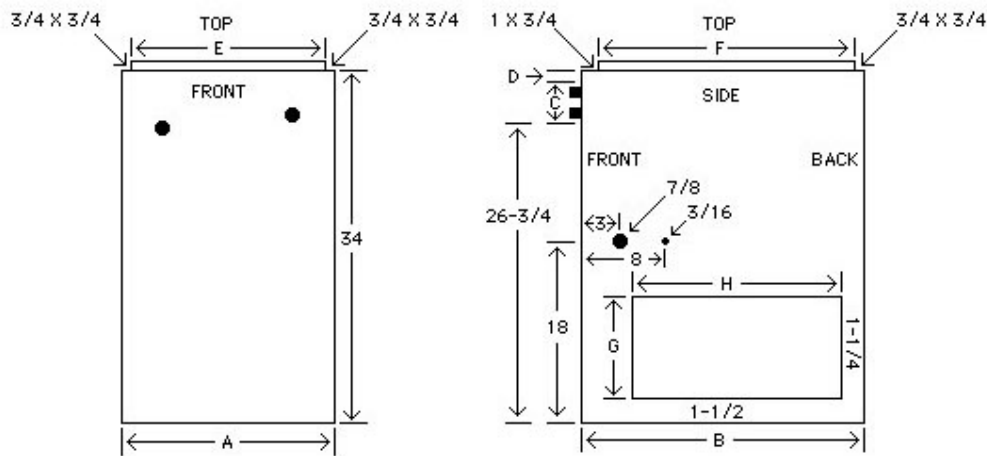

Air Handler Dimensions. All measurements are in inches.

Model	A	B	C	D	E	F	G	H	Water Lines=ID	Shipping Weight=Lbs
AH70	18-1/4	21	5-5/8	1-1/2	16-5/8	19	12	17-3/4	1	105
AH95	18-1/4	21	5-5/8	1-1/2	16-5/8	19	14	17-3/4	1	105
AH115	20-1/4	22-7/8	5-5/8	1-1/2	18-5/8	21	14	17-3/4	1	129
AH135	20-1/4	22-7/8	5-5/8	1-1/2	18-5/8	21	14	17-3/4	1	131
AH150	20-1/4	22-7/8	5-5/8	1-1/2	18-5/8	21	14	17-3/4	1	133
AH180	20-1/4	27-1/8	5-5/8	1-1/2	18-5/8	25-1/4	14	22-3/4	1	148
AH220	25-3/8	28-3/8	5-5/8	1-1/2	23-3/4	26-1/2	14	22-3/4	1	172

Air Handler Specifications. Internal Specifications using water. Entering Air Temperature = 65°

Model	BTUs EWT-200°	BTUs EWT-180°	CFM-Blower Speed-Amps	GMP	APD	Speeds	Approximate FOH-WPD	Approximate LWT at 200°	Approximate LWT at 180°	HP
AH70	77,728	65,958	768-L-3.8	10	.22	3	2.12	183°	166°	1/4
AH95	106,241	90,014	1,158-L-5.1	10	.48	4	2.12	177°	161°	1/3
AH115	126,023	106,850	1,467-M-6.6	12	.53	4	2.58	178°	161°	1/2
AH135	151,856	128,753	1,691-H-7.2	13	.63	4	3.21	175°	159°	1/2
AH150	160,813	136,344	1,769-H-7.4	12	.64	4	3.03	172°	156°	1/2
AH180	197,381	167,314	2,344-H-10.1	13	.65	4	3.66	168°	153°	3/4
AH220	233,373	197,884	2,498-H-10.5	14	.54	4	2.66	165°	150°	3/4

These results have been calculated using a combination of physical testing and computer software designed for the use of developing heat exchangers and related products. These results have been produced by Paukner Metal Products and are believed to be accurate. Actual results may vary depending on installation.